



**NDIS/SDA
LIFESTYLE
HOMES**

 **QLD**

**AVAILABLE
NOW**



**29 Leomatteo Crescent
Kalkie Heights
Bundaberg QLD**



Brand-New 2-Bedroom
HPS SDA Home + OOA

Brand-new High Physical Support SDA Home in Kalkie Heights, Bundaberg

Two bedrooms + OOA, double garage, open-plan living, alfresco area and large backyard – modern, accessible coastal living.

Premium High Physical Support Living in the Beautiful Wide Bay Region

Experience modern, purpose-built **High Physical Support (HPS)** living in the growing Kalkie Heights community.

This brand-new SDA home has been thoughtfully designed to provide independence, comfort, and safety — offering a calm, low-occupancy environment with 24/7 onsite support and a relaxed Bundaberg lifestyle.

HOME HIGHLIGHTS:

- **Two spacious participant bedrooms** – each with private ensuite for privacy and dignity
- **Dedicated OOA room onsite** – ensuring 24/7 support and reassurance
- **Open-plan kitchen, dining and lounge area** – modern appliances, wide access, and natural light throughout
- **Step-free, fully accessible design** – wide doorways, level thresholds, and compliant circulation spaces
- **Double garage with internal access** – secure, convenient and accessible
- **Covered alfresco and spacious backyard** – perfect for outdoor living, entertaining or quiet relaxation
- **Air-conditioning and ceiling fans throughout** – year-round comfort
- **Purpose-built to NDIS SDA High Physical Support standards** – practical, durable and participant-centred



AVAILABLE NOW

29 Leomatteo Crescent, Kalkie Heights
Bundaberg QLD

LOCATION HIGHLIGHTS – KALKIE HEIGHTS SDA LIVING

Enjoy a connected, coastal lifestyle in Bundaberg's newest SDA community:

- Minutes to **Bundaberg Base** and **Friendly's Hospitals**
- Close to **local shops, cafés, schools, and allied health services**
- Short drive to **Bargara Beach** and coastal recreation areas
- Peaceful, family-friendly street with easy access to transport links

IDEAL FOR:

- NDIS participants approved for **High Physical Support (HPS)** funding
- Also suitable for **Fully Accessible (FA), Improved Liveability (IL) or Supported Independent Living (SIL)** participants
- Individuals seeking privacy, independence and modern accessibility in a low-occupancy setting
- Families and Support Coordinators looking for a **trusted, participant-first SDA provider**

✱ A Home That Delivers Comfort and Confidence

Designed for independence and connection, this High Physical Support SDA home offers a stylish, secure and supportive place to live — where everyday living is made easier, safer and more enjoyable.

Vacancy available now

Enquire today to secure your place in this premium Kalkie Heights SDA home.

FLOORPLAN

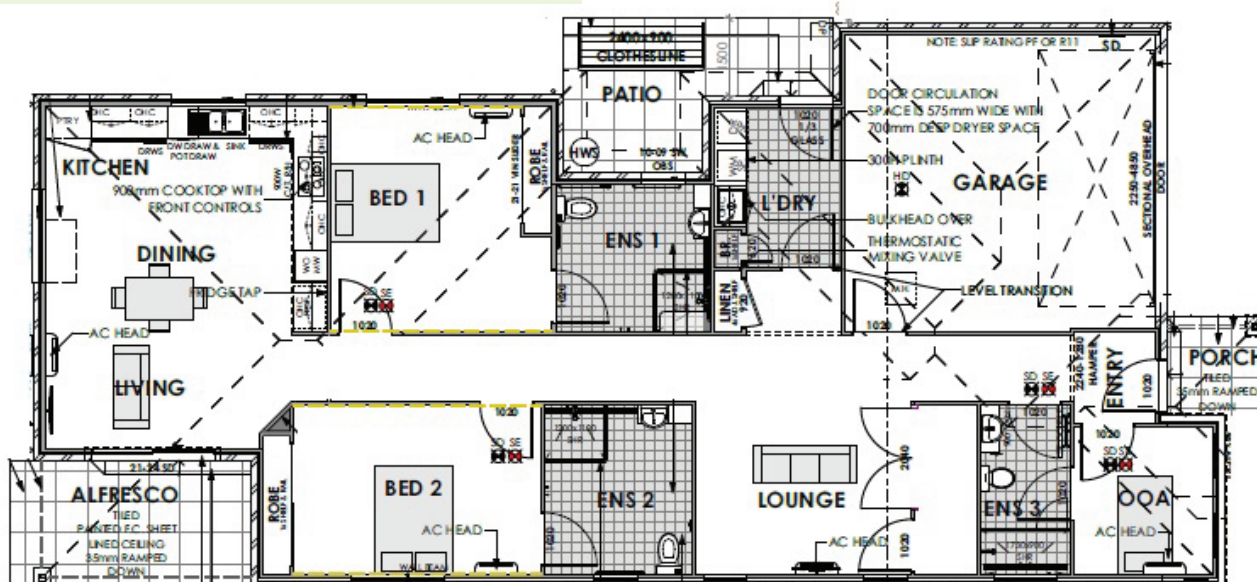

CONTACT

Min Dixon
DIRECTOR

Tel: 0406 886 101
Email: min@ndis-sda.com

