



SDA HOUSING ASSIST
ONE HOME AT A TIME

SHAW QUEENSLAND



- **SDA Home - High Physical Support**
This home is suitable for participants with High Physical Support, Improved Liveability and Fully Accessible funding.



SDA HOUSING ASSIST
ONE HOME AT A TIME

SHAW, QUEENSLAND

Shaw, Queensland is a vibrant and growing suburb known for its welcoming community and family-friendly atmosphere. With easy access to major highways, travel in and out of the area is a breeze, making it convenient for daily commuting or weekend adventures. The suburb boasts a range of modern amenities, including excellent medical facilities and local shops, ensuring residents have everything they need close at hand.

Green spaces and parks are plentiful, offering residents ample opportunities for outdoor activities, picnics, and leisurely strolls. For those who enjoy an active lifestyle, there are plenty of recreational facilities and clubs to join. Shaw is also known for its excellent schools and childcare centers, making it a popular choice for families. The community spirit is strong, with local events and markets bringing neighbors together regularly.

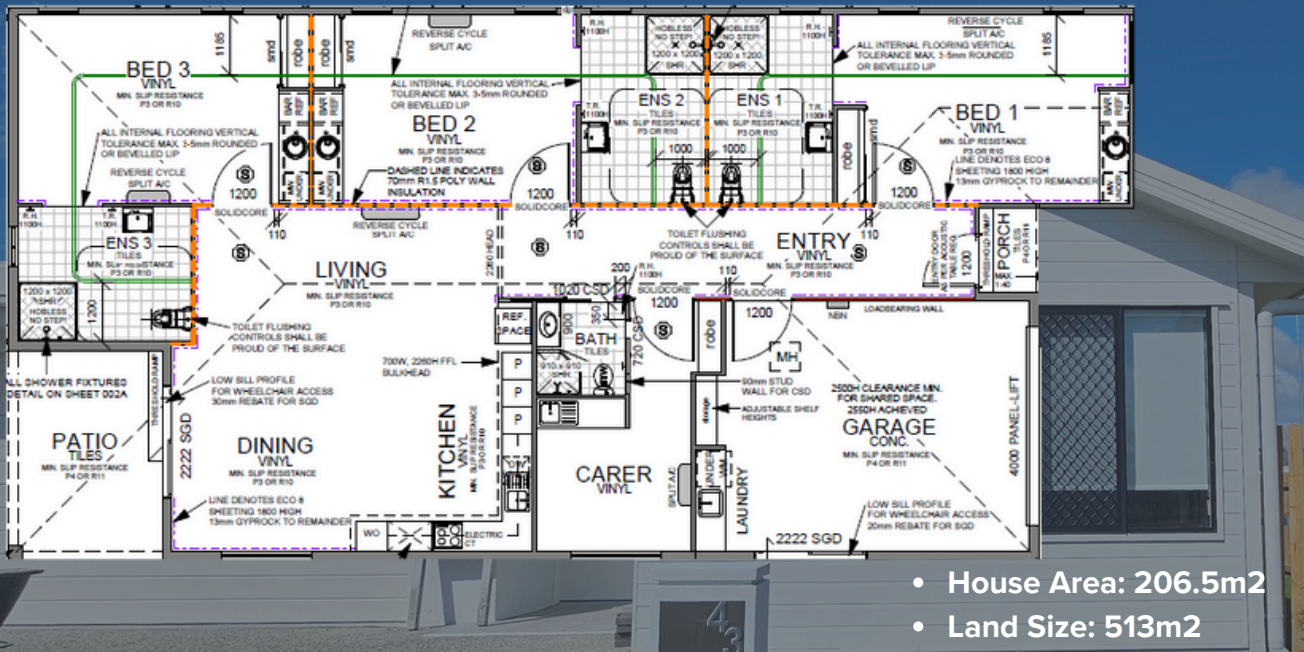

- House Area: 206.5m²
- Land Size: 513m²

- **Location** - 15kms west of Townsville's CBD
- **Airport** - 12min drive to Townsville Airport
- **Hospitals** - 17min drive to Townsville University Hospital
- **Shopping** - 12min drive to Stockland Townsville Shopping Centre

